



jaga

MICRO CANAL

TOP
PERFORMERS

BROCHURE £ UK 2013

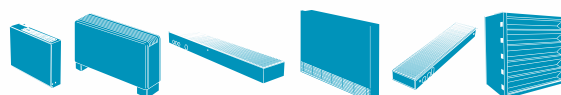



jaga

TOP
PERFORMERS
LOW-H₂O

MICRO CANAL

Maximum warmth, minimum dimensions

The latest Jaga trench heating solution is only 6 cm high and 13 cm wide. With small, but powerful dynamic Low-H₂O heat exchangers and super-quiet fans that are no wider than a thermostatic radiator valve, it creates immense power. Micro Canal combines minimalist aesthetics and architectural freedom with a power that breaks all temperature records! Micro Canal integrates harmoniously with any interior. This provides every architect, designer or engineer the greatest possible design freedom on any project without making any compromises for the heating system.

By using the latest EC motors, Micro Canals consume up to 50% less electricity than traditional motors.





MICRO CANAL

MICRO CANAL



DIMENSIONS (in cm)

Inner casing

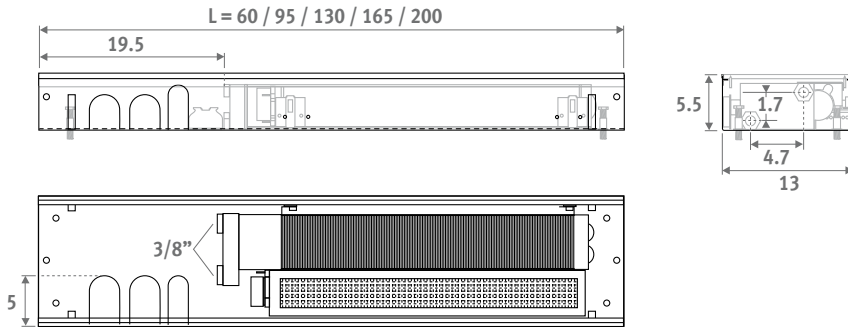

Outer casing

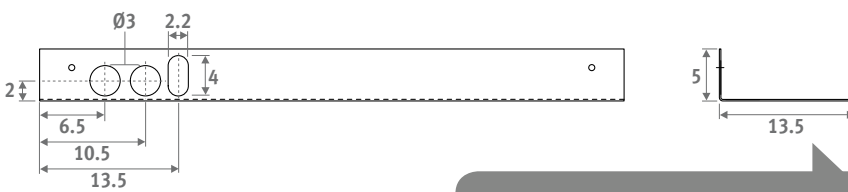

All dimensions +/- 0.2cm

Building in-opening: width 14 cm!

ORDERING CODE

code	height	length	type	grille	colour
MIRF .	006	060	14 .	/SSS	/XXX

fill in colour code with laquered grille

STANDARD DELIVERY

- stainless steel grille
- outer casing with anchorage elements,
- polyethylene-protective mounting block(s) and three connection holes on the left hand side
- pre-assembled internal duct with stainless steel grille support
- tangential activator(s) 24 VDC and integrated stainless steel filter
- dynamic heat exchanger with flexible 1/2" stainless steel connectors (L 15 > 25 cm)
- height adjustment with fine adjustment for alignment with the finished floor.
- automatic activator on/off switch by means of temperature sensor

With energy efficient EC motor

HYDRAULIC CONNECTION

- one-sided 2-pipe connection on the left
- always install Micro Canal with the heat exchanger on the window or wall side
- 2 x 1/2" stainless steel hose included
- allow extra space for curtains, in between the window and the Micro Canal.
- The heat exchanger must always be kept accessible for maintenance purposes
- if the appliance is not mounted flat on the floor, the space between the bottom of the appliance and the floor should be filled with a stable filler material.

ELECTRIC CONNECTION

- clamp connector for electrical connection 24VDC to the left, to be connected via external power supply. Install a thermostat with a potential-free contact to control the water supply with the help of a zone valve. Micro Canal automatically switches on the activators via a temperature sensor.

COMPOSITION

Stainless steel grille(s).

Stainless steel air filter

Tangential EC thermic activator(s)

Dynamic heat exchanger

Stainless steel flexible connections 1/2"
Length 15 cm

Inner casing
with stainless steel
grille support

Fine adjustment
up to 1 cm, for a perfect
alignment with the
finished floor

Outer casing

Anchoring of the inner
housing after fine adjustment

Connections always on the left

Anchorage elements / height control from 6.2 to 8 cm

MICRO CANAL

MIRF.HHH LLL TT/XXX



H	L	T	HEATING			ACTI-VATORS	SOUND PRESSURE*	POWER CONS.	AIR FLOW	WATER FLOW	£ /SSS	£ /SSC/XXX
			Watts 75/65/20°C	Watts 55/45/20°C	Watts 45/38/20°C							
006	060	14	390	234	167	1	18.0	1.3	34	34	642.10	706.30
	095		780	468	334	1	21.0	1.7	57	67	942.90	1037.20
	130		1170	702	500	1	22.8	2.0	101	101	1258.90	1384.80
	165		1560	936	667	2	24.0	3.4	134	134	1579.80	1737.80
	200		1950	1170	834	2	25.0	3.7	168	168	1890.80	2079.80

EN442 output at 20°C room temperature

* Height 1 metre, 2 metres from the air exhaust grille.

Correction factors & pressure drop: see "Technical info" chapter

OVERVIEW GRILLES

Stainless steel grilles



SSS
stainless steel

Stainless steel grilles lacquered

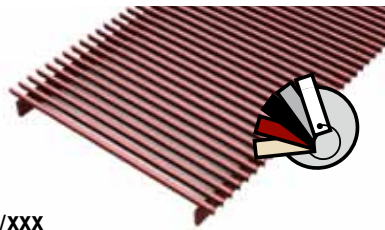

SSC/XXX
stainless steel lacquered

To ensure perfect adherence of the lacquer coating, an extremely wear-resistant and UV-resistant polyester lacquer coating of the highest quality is used. Only in glossy (code 2..)

Complete installation and user manual see: www.jaga.co.uk

ASSEMBLY & PROTECTION BLOCK

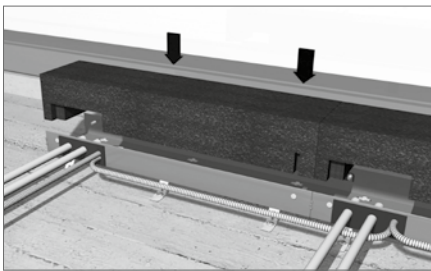

Install the polyethylene protective block(s) as protection on the construction site.

DESIGN GRILLES

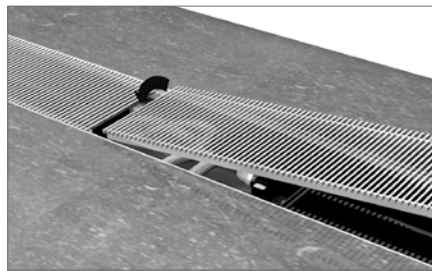

Continuous design grille of stainless steel grilles.

HEIGHT CONTROL

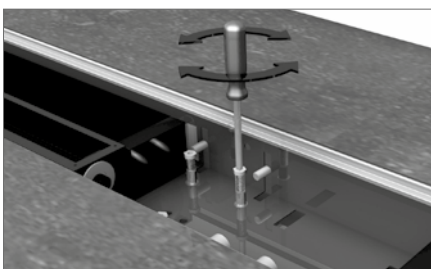

Double height adjustment by means of the anchoring on the outer casing and by fine adjustment with the bolts in the inner housing (adjustable from 6.2 to 8 cm).

FLEXIBLE CONNECTION

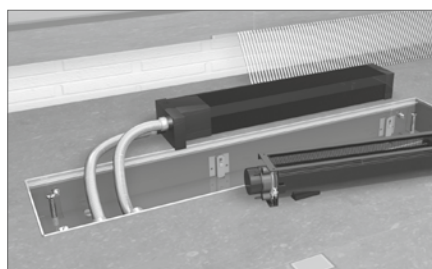

Stainless steel flexible hoses (15 to 25 cm), enabling the internal mechanism to be removed completely for easy cleaning.

MICRO CANAL - OPTIONS

POWER SUPPLY



The guarantee is only valid if the original Jaga power supply is used.

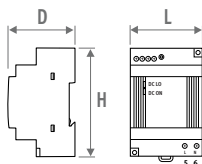

Code	H	L	D
7990.050	9.1	5.3	5.5
7990.051	9.1	7.1	5.5
7990.052	9.1	8.9	5.5
7990.053	12.5	8.3	11.6

- for DIN-rail or wall mounting
- safety: UL1310 Class 2
- output voltage between 24 - 28 VDC
- input voltage 90 - 264 VAC
- screw connection
- LED display
green = on
red = DC low power / short circuit

CODE	Output	Output	£
	Watts	current A	
7990.050	31	1.3	63.70
7990.051	60	2.5	81.30
7990.052	100	4.2	99.00
7990.053	240	10	109.60

Required power = sum of the power consumption of the devices

MAX. CABLE LENGTH (in metre)

Number of ventilators	Min. cable thickness mm ²				
	2.5	1.5	1	0.75	0.5
5	411	247	165	123	82
10	206	123	82	62	41
15	137	82	55	41	27
20	103	62	41	31	21
25	82	49	33	25	16
30	68	41	27	21	14
35	59	35	24	18	12
40	51	31	21	15	10
45	46	27	18	14	9
50	41	25	16	12	8

Cable length in function of the number of fans (max. volt drop 5%)

CONNECTION SET 24 VDC



CODE	Description	£
7990.210	180° - G1/2" F / NG 24V 2Watts	94.60

- with varistor to protect against power surge
- with position indicator (open/closed)

JAGA TWO-WAY VALVE AND MOTOR 230V



CODE	Description	£
7990.409	180° - G1/2" F / NG 230V 2Watts	59.50
7990.411	180° - G3/4" F / NG 230V 2Watts	67.90

- only for mounting on the distributor, not in the Micro Canal!
- with varistor to protect against power surge
- with position indicator (open/closed)

VALVE UNIT



- length 35 cm
- motorised thermostatic valve 24 VDC with lockshield
- outer casing with height control
- inner casing with stainless steel grille support
- stainless steel grille, natural coloured or lacquered
- protection block

CODE	£
7522.00603514/SSS/VC	367.40
7522.00603514/SSC/.../VC	403.80

fill in colour code

Jaga Thermostatic valve 5090.405
motor 24 VDC



lockshield 5090.110

Dimensions of the valves, see "Connection sets & valves" chapter.

MICRO CANAL - OPTIONS



EMPTY HOUSING

To fill open spaces for a continuous installation



- outer casing with height control
- inner casing with stainless steel grille support
- stainless steel grille, natural coloured or lacquered
- protection block(s)
- 2 head pieces

Empty housing with stainless steel grille

CODE	L	£
7522.00603514/SSS	35	266.80
7522.00606014/SSS	60	358.20
7522.00609514/SSS	95	505.00
7522.00613014/SSS	130	662.90
7522.00616514/SSS	165	815.70
7522.00620014/SSS	200	973.50

Empty housing with lacquered stainless steel grille

CODE	L	£
7522.00603514/SSC/ ...	35	293.50
7522.00606014/SSC/ ...	60	422.00
7522.00609514/SSC/ ...	95	599.10
7522.00613014/SSC/ ...	130	788.30
7522.00616514/SSC/ ...	165	973.50
7522.00620014/SSC/ ...	200	1162.80

fill in colour code

CORNER PIECE

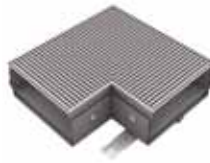

- aluminium grille in stainless steel effect (SSS), or lacquered in other Jaga colours (SSC)
- outer casing with anchorage elements
- polyethylene-protective mounting block(s)
- fully assembled inner housing with stainless steel grille support
- height adjustment with fine adjustment for alignment with the finished floor

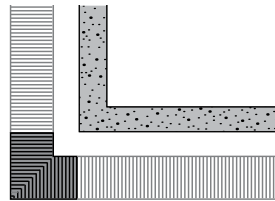

Inner corner

CODE		£
7522.00602014/SSS/01	natural	246.90
7522.00602014/SSC/.../01	lacquered	271.20

fill in colour code

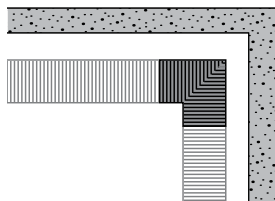

Outer corner

CODE		£
7522.00602014/SSS/02	natural	246.90
7522.00602014/SSC/.../02	lacquered	271.20

fill in colour code

FEET WITH HEIGHT ADJUSTMENT FOR RAISED FLOORS

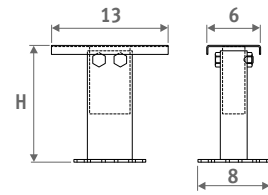

- lacquered in dark grey RAL 7024.
- easy installation by means of "stainless steel spring system"

Number of feet per Micro Canal

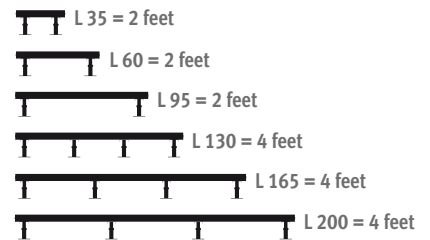

CODE	H	£/foot
5207.05070000	5 > 7 cm	37.70
5207.08130000	8 > 13 cm	38.80
5207.13230000	13 > 23 cm	40.90
5207.20300000	20 > 30 cm	41.60

Jaga Heating Products (UK) Ltd
Orchard Business Park
Bromyard Road
Ledbury, Herefordshire HR8 1LG

Tel.: +44 1531 631 533
Fax: +44 1531 631 534
E-mail: jaga@jaga.co.uk

www.jaga.co.uk

Jaga International
Verbindingslaan z/n
B-3590 Diepenbeek

Tel.: +32 11 29 41 16
Fax: +32 11 29 41 60
E-mail: export@jaga.be

WWW.
THE RADIATOR FACTORY
.COM

WWW.JAGAEXPERIENCELAB.COM

your partner:

